

NOT STANDARD:
 - CABIN PREPARED FOR FLOOR COVERING AT CUSTOMER EXPENSE (FLOOR THICKNESS 20 mm - MAX WEIGHT 30 Kg)

NOTE:
 - ELECTRIC PANEL WITH MICROCONTROLLER CARD AND MULTIVISION DISPLAY

STANDARD ACCESSORIES:
 - REMOVABLE ENABLING KEY FOR THE CABIN BUTTON PANEL
 - REMOVABLE ENABLING KEY FOR THE FLOOR BUTTON PANEL
 - PUSH BUTTON PANEL VERTICAL
 - POLISHED STAINLESS STEEL CABIN HANDRAIL

NOT STANDARD ACCESSORIES:
 - FULL HEIGHT INFRA-RED CURTAIN
 - AUTO DIALER EXCLUDED

ATLANTIS - RW 375
 Lamiera zincata
 INOX BA (Lucido)
 ESCLUSO DALLA FORNITURA
 Verticale a n° 6 fori

Disegno Labirint Bianco A1 - NEON 230V
 INOX BA (Lucido) (oper. Prisma "Micro Std")
 INOX BA (Lucido)
 INOX BA (Lucido)
 Similinox F12PPS

Shaft typology: MASONRY		Sheet	Scale	first draft	FINAL DESIGN DRAWINGS
Stops: 3	Doors: 3	1/2	A3	28/05/2013	final drawing
cabin mass and operators (Kg) 375		1/15	D. Tomei	10/09/2013	
panels					
finishings					
floor					
push button panel					
roof					
cabin doors colour					
landing doors colour					
frame landing doors colour					
electrical s. cabinet colour					
Modifications					
d.					
c.					
b. Q.E. era Inox BA e dist. 4000; fermate erano "1 2 3"; predisp. pavimento era 15; corsa era 6090; fossa era 330.					10/09/2013
a. fossa era 300; testata era 2800; cabina era h 2060.					27/06/2013
Rif. 88936					ENERGY
ORDER NUMBER					
EN365					



Provide an inspectionable canalization to allow the way to the piping and to the electrical installation.

Handing switchboard at floor B, protected against water leaks and inside of the building.

blancing mass P (N) 29121
cabin N (N) 40611

Thrust during normal operation
Fx (N) 1502
Fy (N) -811
s (N) 6282
d (N) 6282

s' (N) 5630
d' (N) 5630

Thrust of safety gear device intervention
Fx (N) 2503
Fy (N) 2925
s (N) 1340
d (N) 21645

s' (N) 688
d' (N) 688

reference directive 95/16/CE
maneuver universale
voltage of the battery charger (V) 230V
batteries 12V 27Ah

reduction gear STM PLM65 1/21,1
motor TTN209D 42Vcc 2070W 66A
block brake 23 N/m - 24V

arcade 950-m140x1100-H2510
safety gear LVT2000 DX P+Q=962-1118 KG n. 2

arcade mass (Kg) 165
balancing (%) 49
balancing mass (Kg) 725
lamiere sp. 5 mm n° 176
suspension cables WOLF n° 6x6,5
length (mm) 10000
minimum breaking load (N) 31500

balanc. mass shock absorbers ETN 125 x 80
cabin shock absorbers ETN 125 x 80
cabin guides T80x80x9 x 9020 mm - staffe n° 7
balancing mass guides T45/A x 9020 mm

max speed (m/s) 0,5
load capacity (Kg) 480
people capacity 6

Interfloors

2/3 = 3310 mm
1/2 = 2790 mm

THE QUOTES ON THE VERTICAL SECTIONS ARE NOT IN SCALE

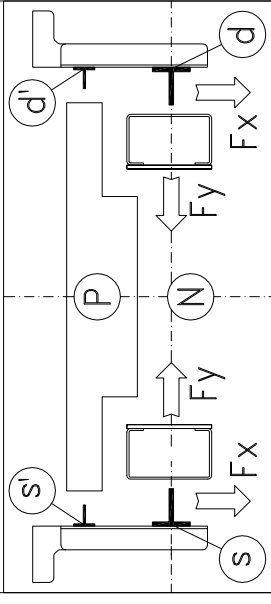

SECTION B-B
VENTILATION ON THE TOP OF THE SHAFT COMPLYING TO THE EXISTING NORMATIVES

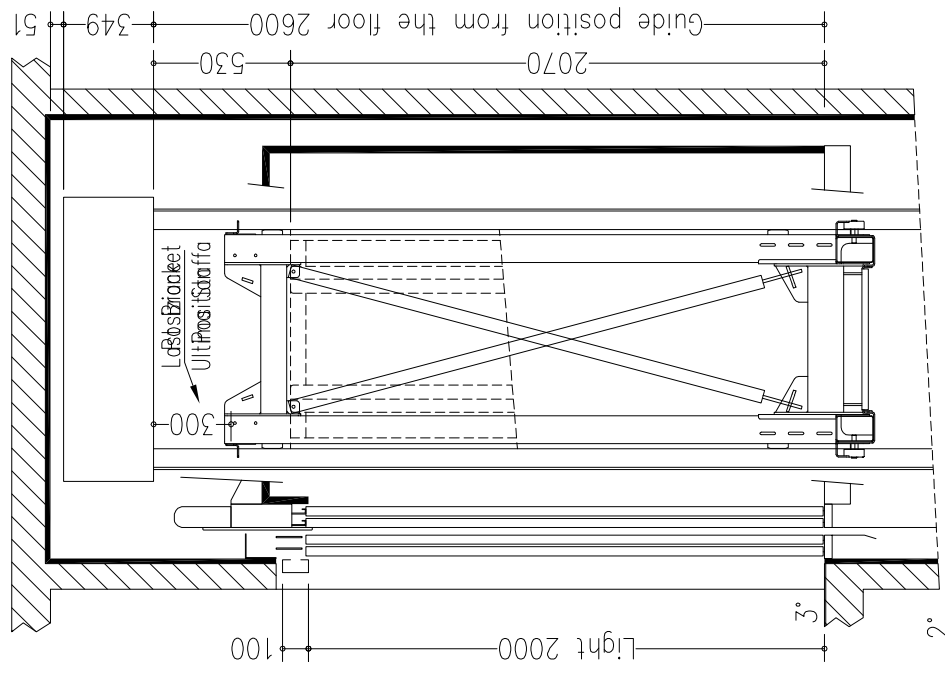

SECTION A-A
VENTILATION ON THE TOP OF THE SHAFT COMPLYING TO THE EXISTING NORMATIVES

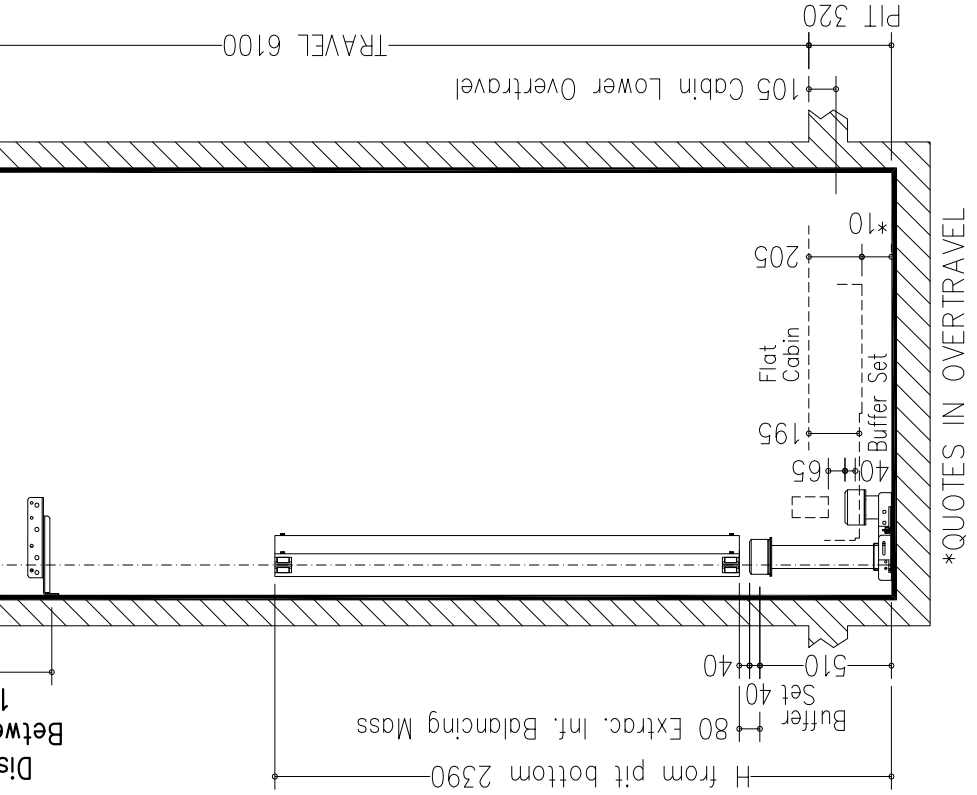
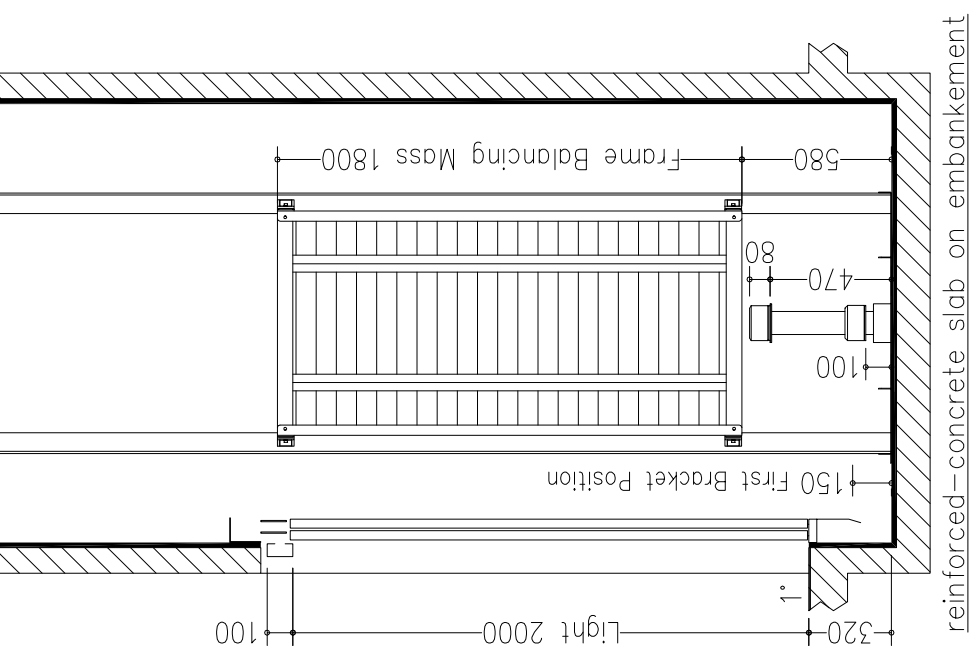
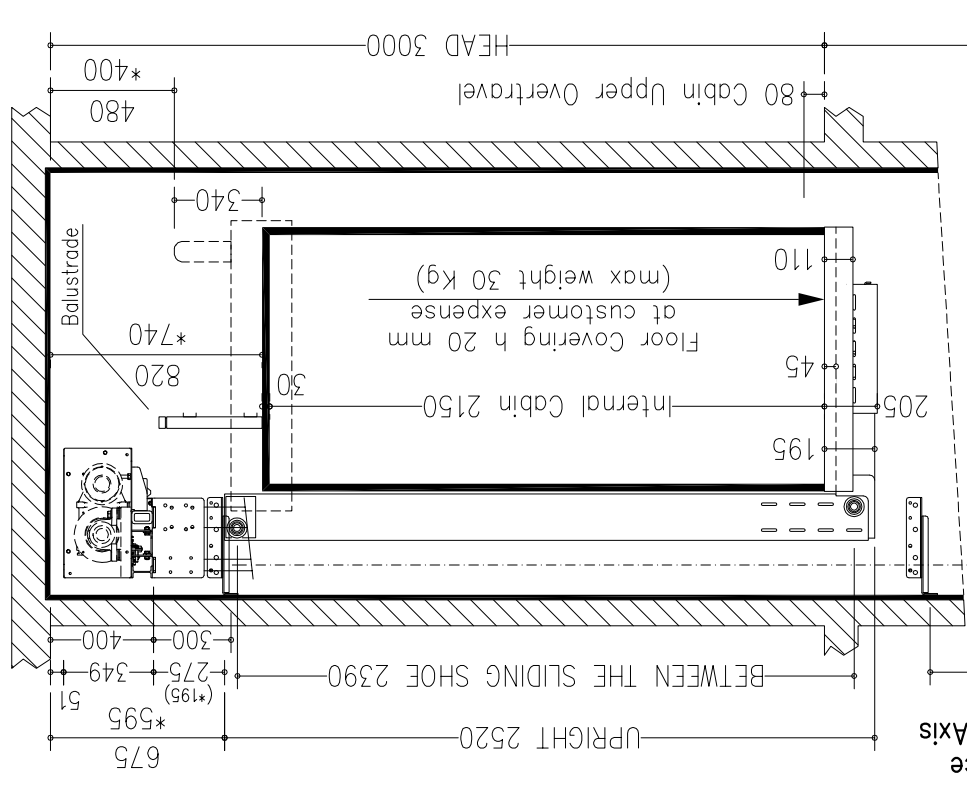

NOTES FOR THE CUSTOMER
THE HORIZONTAL AND VERTICAL LOAD BEARING STRUCTURES MUST BE ABLE TO SUSTAIN THE LOADS INDICATED. THE HOISTWAY SHAFT MUST BE VENTILATED ACCORDING TO THE EXISTING NORMATIVES AND CONSTRUCTED IN ORDER THAT ALL EQUIPMENTS INSIDE IT ARE PROTECTED FROM DUST, UNHEALTHY VAPOUR AND HUMIDITY. THE DIMENSIONS OF THE LEVATOR SHAFT MUST BE GUARANTEED WITH AN ALLOWANCES OF 1 CM AND THE WALLS MUST BE PERFECTLY PLUMBED. IN THE CASE IN WHICH THE PIT IS MORE THAN 500 MM BUILT-IN STEPS ARE NECESSARY (140X100X400). THE CUSTOMER HAS TO WATERPROOF THE PIT AFTER THE FIXING OF THE EQUIPMENT IN THE PIT BOTTOM. THE PROJECT IS COMPILED IN ACCORDANCE TO THE EXISTING NORMATIVES.

FOR APPROVAL OF EVERYTHING CONCERNING THE MASONRY PARTS OF THE SHAFT.

DATE _____ SIGN _____

Shaft typology: MASONRY

Stops:	3	Doors:	3	Sheet	2/2
Sheet dimension	A3	Scale	1/30	D. Tomei	28/05/2013
final drawing	10/09/2013				

first draft	28/05/2013	D. Tomei
final drawing	10/09/2013	

Modifications
a | Q.E. era Inox BA e dist. 4000; fermate erano "1 2 3"; predispos. pavimento era 15; corsa era 6090; fossa era 330.
b | fossa era 300; testata era 2800; cabina era h 2060.

10/09/2013	D. Tomei
27/06/2013	D. Tomei

MODEL ENERGY

reinforced-concrete slab on embankment

*QUOTES IN OVERTRAVEL