

## FLOOR DOOR

Side B	Side C	Side D	VERSION	H LIGHT	H FRAME	FRAME	WINDOW	GLASS	ACCESSORIES
G 1			2 Panels RAL 9006	2000	2210	RAL 9006	Absent		C2

C1 = Enabling key for the floor button pad (single insertion) C2 = Enabling key for the floor button pad (double insertion) PM = Button pad on the wall PE = Outside lock and button pad

### Shaft V52 ()

ENVIRONMENT	VERSION	Cladding	START	ROOF	ANCHORAGE
Outside	G + RAL *	See pages 3 and 4	Pit bottom	For Outside	Anchorage to care of the Customer. Ancoraggio a cura del Committente.
Esterno	Z + RAL *	Vedi Pag. 3 e 4	Fondo Fossa	Per esterno	

(\*) Galvanized and RAL 9006

(\*) Zincata e RAL 9006

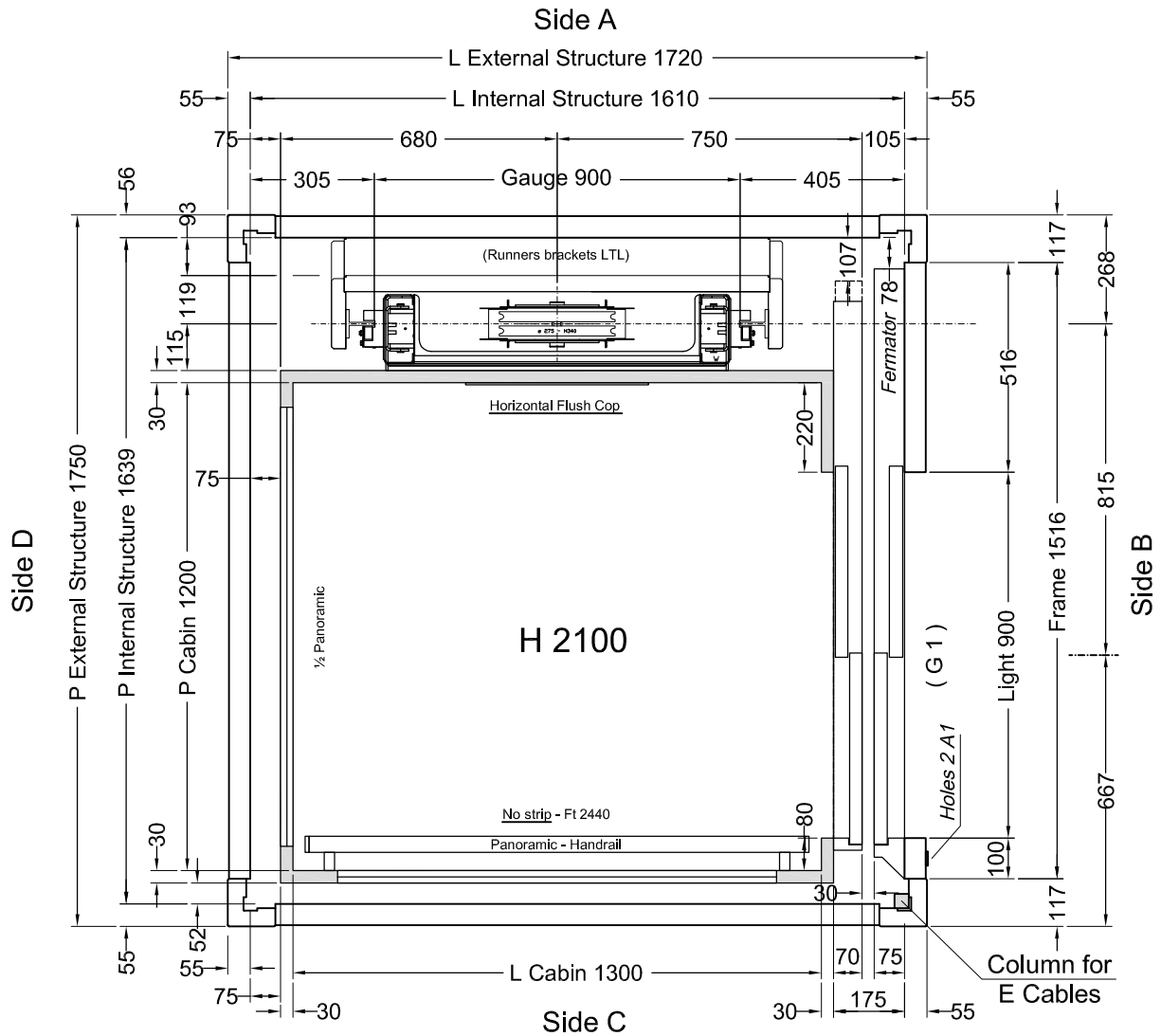

**Stops: 2 - Doors: 2**

Shaft in **Shaft V52 ()**

**Feasibility n° 2440 - Wall Side C**

		Date	Final Drawings	
			Model	SHEET
			ELFO 2	1/4
		28/07/2015		SHEET DIMENS.
		13/07/2015		A3
		1° STESURA		SCALE
		28/07/15		1:12.5
		AREA m <sup>2</sup>	CAPACITY	
		1,56		



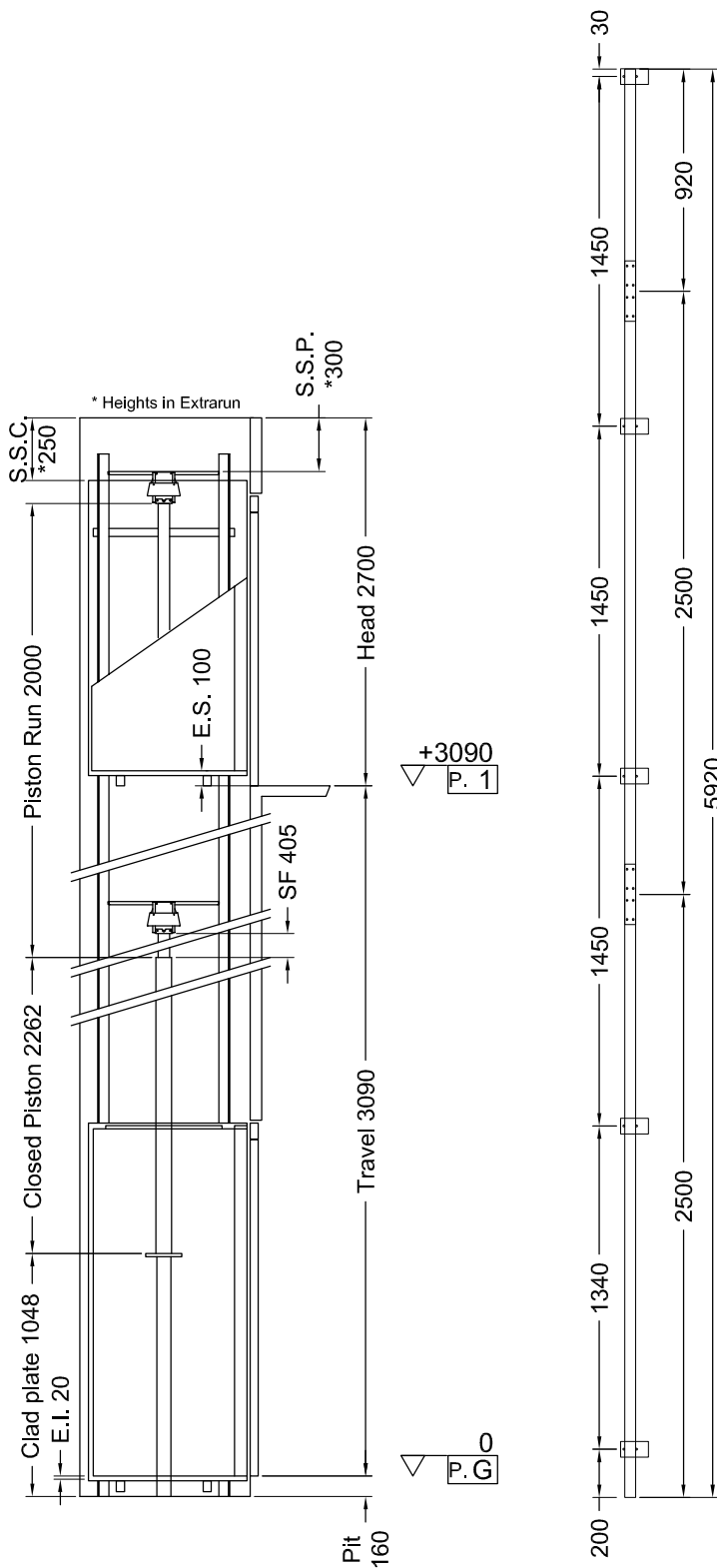

**Indirect Installation**      Speed **0,3 m/s**      28/07/15 15.09 (V.2852) GND

THRUST DURING NORMAL OPERATION				THRUST OF SAFETY DEVICE INTERVENT.			
P	(N)	<b>13531</b>		P	(N)	550	
N	(N)	<b>548</b>		N	(N)	9019	
F1	(N)	<b>1858</b>		F1	(N)	3097	
F2	(N)	<b>353</b>		F2	(N)	588	

SPACES		PRESSURES		
E.I.	Extrarun below cabin (mm)	<b>20</b>	Max static pressure (bar)	<b>43,59</b>
E.S.	Extrarun above cabin (mm)	<b>100</b>	Min static pressure (bar)	<b>25,74</b>
SF.	Piston extraction (mm)	<b>405</b>	Overpressure limit (bar)	<b>61,02</b>
S.S.P.	Piston/head (mm)	<b>300</b>	Residual pressure (bar)	<b>1,43</b>
S.S.C.	Cabin/head (mm)	<b>250</b>		

HYDRAULIC UNIT		MECHANICAL PARTS	
Central unit	<b>GMV HL 3010 (-*)</b>	Guide rails	<b>70x70x9</b>
Capacity (l/min)	<b>35</b>	Brackets	(Nr) <b>5</b>
Motor (V)	<b>MF230V</b>	Ropes	Ø <b>11 mm 6-(1+9+9)</b>
Power (Kw)	<b>3,4</b>	Cables lenght (mm) 2 x	<b>9000</b>
Nominal current (A)	<b>32</b>	Min actual breaking load (N)	<b>70700</b>
Piston	<b>Start Home (ø)70x5x2000</b>		
Opt. oil position	<b>BASSO</b>		
Tubing	<b>3/4" EN 853 1SN - FD 3/4" - GOMITO 3/4"</b>		
Tubing lenght (mm)	<b>6000</b>		
Min hydraulic oil (L)	<b>40</b>		

SECURITY DEVICES	Manufacturer	Model	Certificate
Safety Gear	<b>PFB</b>	<b>BP1</b>	<b>TÜV AFV515</b>
Block Valve	<b>START ELEVATOR</b>	<b>1/2" 0327</b>	<b>CA50.00525</b>
Key Locks	<b>FERMATOR</b>	<b>210/10/40</b>	

MACHINERY LOCATION			
At floor	<b>G</b>	Length of the hose travel	<b>2000 (mm)</b>
Cables enter in shaft: Side	<b>A</b>		

CABIN		CABIN ACCESSORIES	
Panels	<b>F41PPS</b>	½ Panoramic	<b>Side D</b>
Finishes	<b>F41PPS</b>	Panoramic	<b>Side C <u>No Strip</u></b>
Oper. panel	<b>Horizontal Flush mounted **</b>	Handrail	<b>Inox S.B., Side C</b>
Floor	<b>121-043 - Leaf Green</b>	Outside covering	<b>Side C, D, Roof</b>
Ceiling	<b>SPOTS LED - F41PPS</b>	Outside finishing	<b>F41PPS</b>
Cabin Doors	<b>Side B: 2-Panels Automatic Sliding doors, F41PPS</b>		
<b>(**) Inox Scotch Brite</b>			

- OTHER ACCESSORIES**
- Enabling key for the cabin button pad, double insertion
  - Guides dlmension 2.5 m
  - Manual pump
  - Manostat with overweight signal
  - Two speed
  - Open Door button in cabin
  - False head device
  - Telephone by Lift Shop
  - Full height infra-red curtain V2
  - Roof covering
  - Automatic Control 2011
  - Cabin Buttons: **G 1**
  - Call Accept
  - Emergency manual descent from cabin

