

The award winning leader

E1 SHAFT BY BUILDER • DRIVE TO RIGHT OPPOSITE THROUGH CAR • 1100 x 1400 CABIN

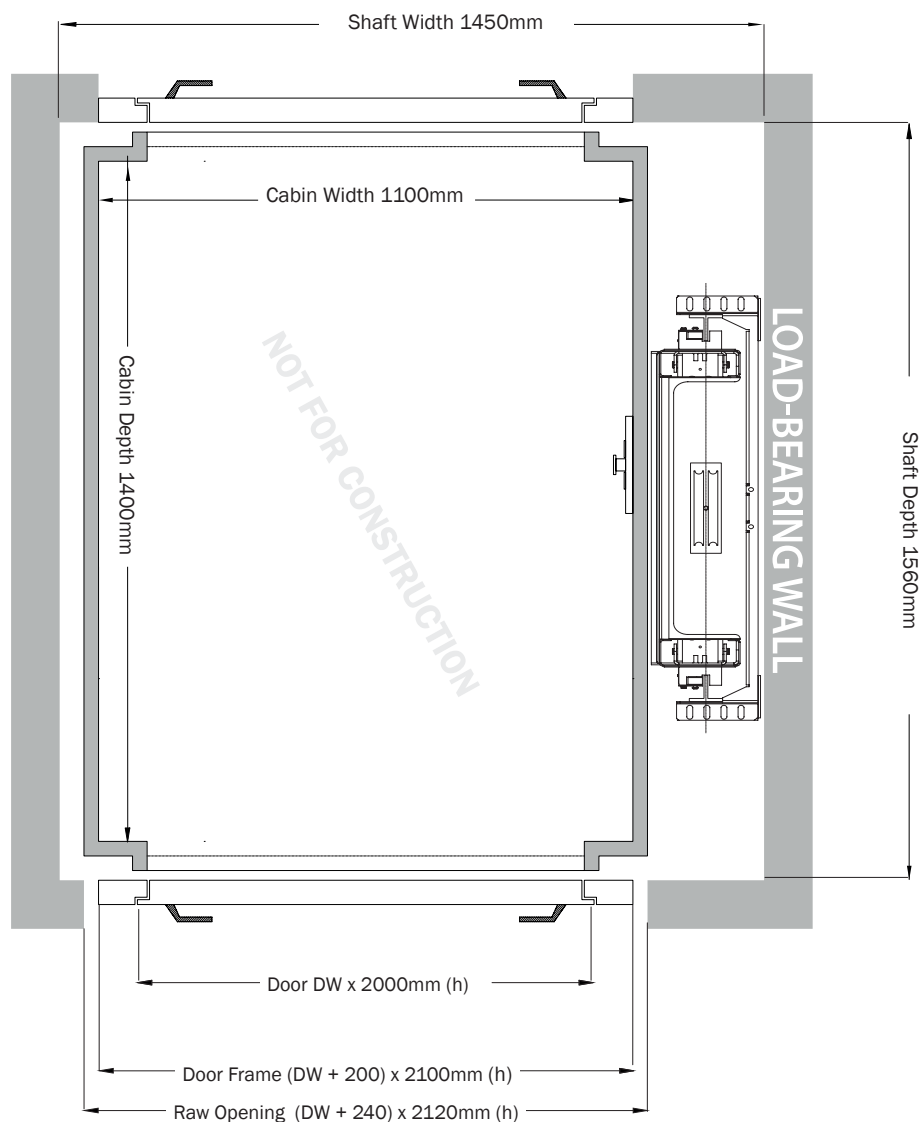

1100mm (w) x 1400mm (d) is compliant limited mobility access

This layout drawing is for guidance only please contact our sales and design consultants to ensure your complete understanding of your lift requirements

CONSTRUCTION DETAILS

- Construction material re-inforced blockwork or equivalent
- Internal shaft size 1450mm (w) x 1560mm (d)
- Pit depth 130mm - 150mm
- Headroom 2600mm (smaller is possible)
- Lift machine area up to 7m away at landing of choice
- Power supply single phase 240V 32A or 3 phase 415V 20A
- Doors sizes from 450mm - 1000mm in 50mm increments
different jambs may have alternate impact

STANDARD SPECIFICATIONS

- Person capacity 300 - 350 - 400 - 500kg
- Speed 0.30 m/s
- Maximum travel 12m
- Safety protection full height sensor beams
- Maximum floors 6
- Compliance AS1735.18
- Cabin fit out from our huge range of options
- Doors finishes from our huge range of options