

FLOOR DOOR

Side B	Side C	Side D	VERSION	H LIGHT	H FRAME	FRAME	WINDOW	GLASS	ACCESSORIES
B			*	2000	2100	*	Mono PS1	Transparent	C2 - CASPIM
	G 1		**	2000	2100	**	Absent		

C1 = Enabling key for the floor button pad (single insertion) C2 = Enabling key for the floor button pad (double insertion) PM = Button pad on the wall PE = Outside lock and button pad

* Standard RAL 9010 Semi polished smooth finish - no raised edges

** Standard Rust-proof - no raised edges

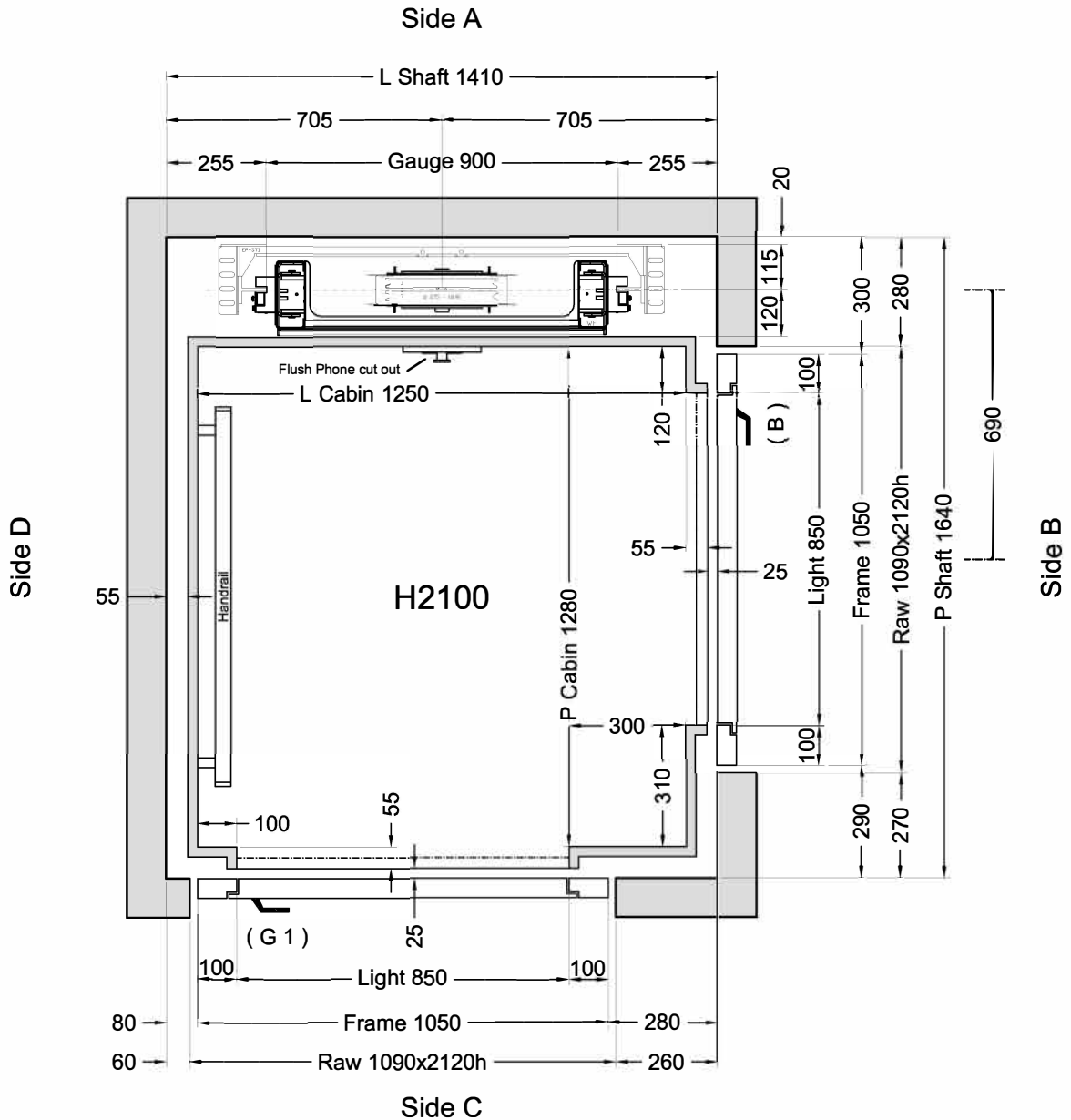

Stops: 3 - Doors: 3

Shaft in **Reinforced concrete (Cemento armato)**

ORDER	VERSIONS	Description	Designer	Date	Final Drawings	
ORDER NUMBER					Model	SHEET
					ELFO	1/2
		modifiche varie	D.Ogliastro	10/08/2016		SHEET DIMENS.
						A3
		CLIENT Lift Shop	Final Drawings D.Ogliastro	1° STESURA 30/08/16		SCALE
		PLACE OF INSTALLATION	CAPACITY	AREA m ²	CAPACITY	1:12.5
			350 Kg	1,6		



Indirect Installation Speed 0,3 m/s 30/08/16 16.20 (V.2910) ^{GD}

THRUST DURING NORMAL OPERATION			THRUST OF SAFETY DEVICE INTERVENT.		
P	(N)	12013	P	(N)	707
N	(N)	967	N	(N)	8269
F1	(N)	1941	F1	(N)	3234
F2	(N)	387	F2	(N)	645

SPACES		PRESSURES		
E.I.	Extrarun below cabin (mm)	20	Max static pressure (bar)	37,58
E.S.	Extrarun above cabin (mm)	100	Min static pressure (bar)	19,74
SF.	Piston extraction (mm)	132	Overpressure limit (bar)	52,61
S.S.P.	Piston/head (mm)	340	Residual pressure (bar)	1,84
S.S.C.	Cabin/head (mm)	315		

HYDRAULIC UNIT		MECHANICAL PARTS	
Central unit	GMV HL 3010 (-*)		
Capacity (l/min)	35	Guide rails	70x70x9
Motor (V)	TF400V	Brackets	(Nr) 7
Power (Kw)	2,9	Ropes	Ø 11 mm 6-(1+9+9)
Nominal current (A)	11	Cables length (mm) 2 x	13000
Piston	OMARLIFT HC (ø)70x5x4000	Min actual breaking load (N)	70700
Opt. oil position	BASSO		
Tubing	3/4" EN 853 1SN - FD 3/4" - FD M30X2		
Tubing length (mm)	5000		
Min hydraulic oil (L)	51		

SECURITY DEVICES	Manufacturer	Model	Certificate
Safety Gear	PFB	BP1	TÜV AFV515
Block Valve	OMARLIFT	HC-34	TÜV 44 208 07 352266 004
Key Locks	Prudhomme	PLT/L/CPX NL 11-400-1002-125-02	

MACHINERY LOCATION			
At floor	B	Length of the hose travel	1000 (mm)
Cables enter in shaft: Side	A		

CABIN		CABIN ACCESSORIES	
Panels	Lamiera zincata	Handrail	INOX S.B., Lati D
Finishes	Inox Scotch Brite	Outside covering	Roof
Oper. panel	VERTICAL	Outside finishing	F41PPS
Floor	TOUCH 2424		
Ceiling	SPOTS LED - Avorio PPS11		

OTHER ACCESSORIES
Automatic Control 2011
Two speed
Return to the lower floor after adjustable time
Handles CASPIM (Long) (floor B)
Doors without handles (and without holes for handles) (floor G, 1)
Flush Phone cut out on cop
Cabinet: F41PPS
Full height infra-red curtain V2
Power supply 400V 3 phase
Shaft lighting
Roof covering
ICARO display in cabin on COP
Call Accept Emergency manual descent from cabin
Enabling key for the cabin button pad, double insertion
Guides dimension 2.5 m

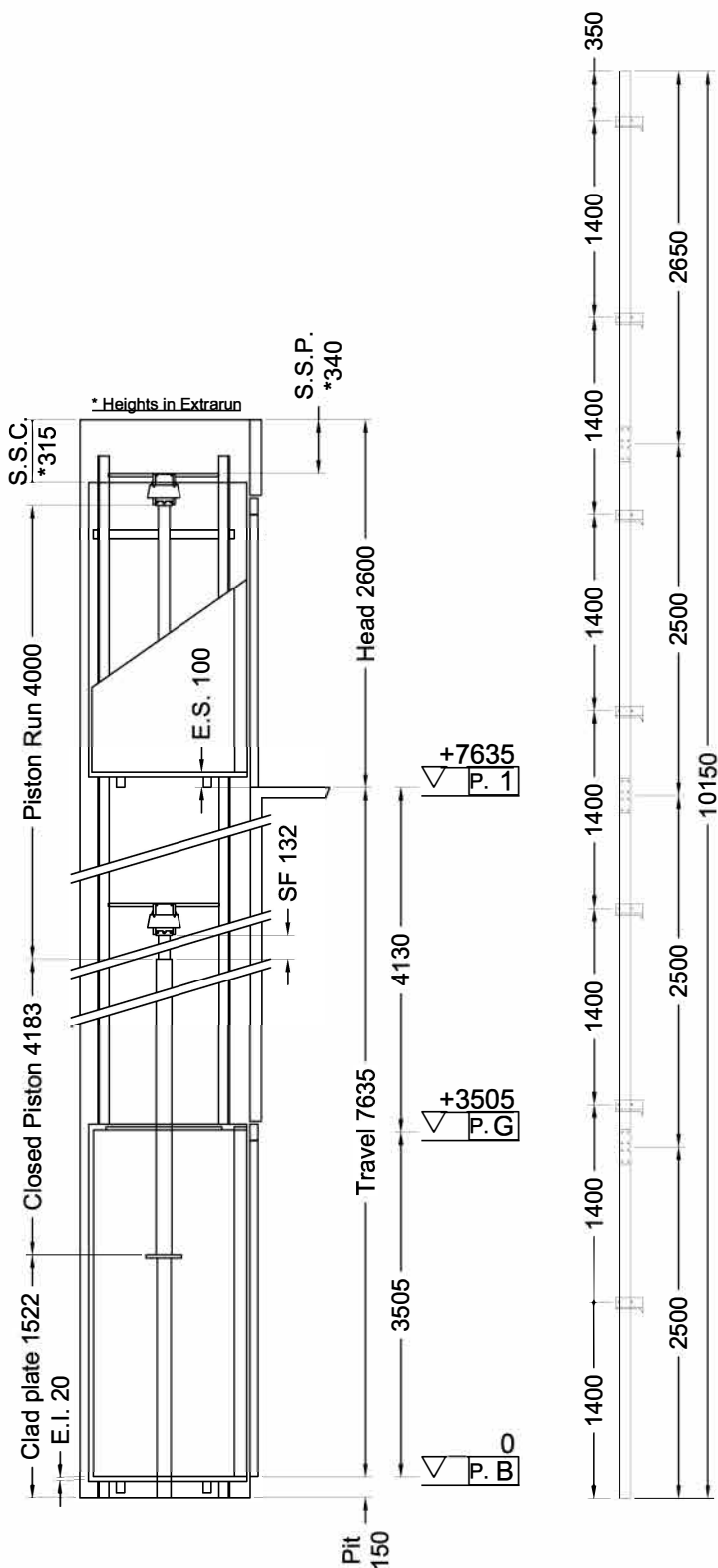

ORDER	CLIENT	Final Drawings	1° STESURA
ORDER NUMBER	Lift Shop	D.Ogliastro	30/08/16
	PLACE OF INSTALLATION	Final Drawings	
		SCALE	SHEET
		OUT OF SCALE	2/2