

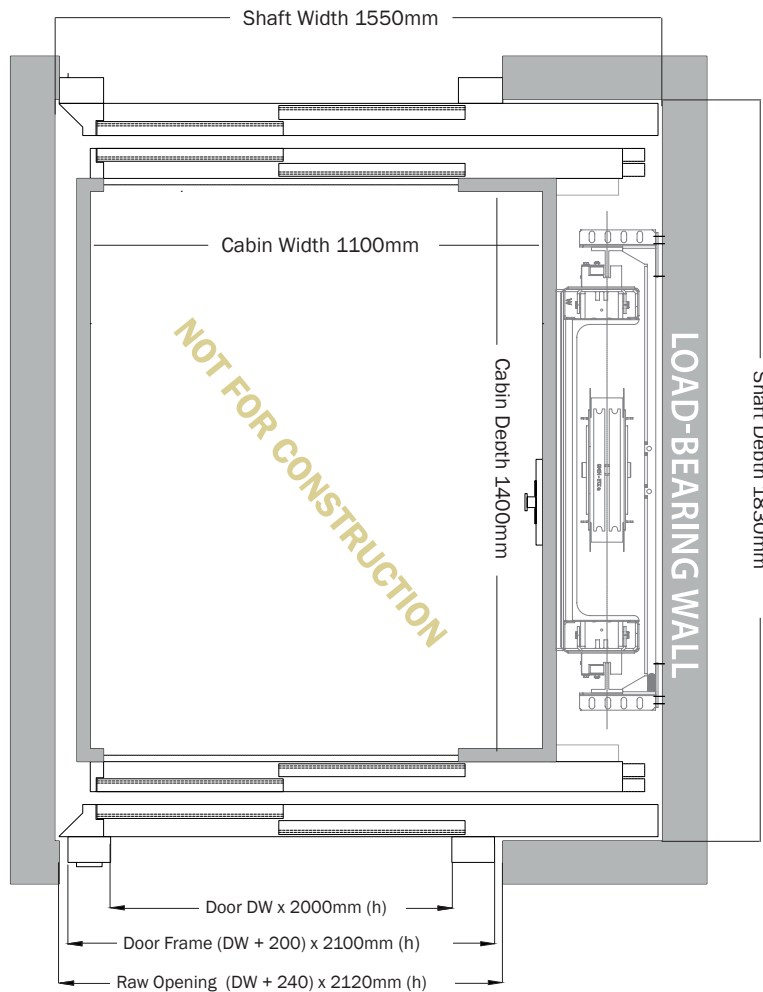

**E2**

# SHAFT BY BUILDER • DRIVE TO RIGHT OPPOSITE OPENING • 1100 x 1400 CABIN



1100mm (w) x 1400mm (d) is compliant limited mobility access

This layout drawing is for guidance only please contact our sales and design consultants to ensure your complete understanding of your lift requirements

## CONSTRUCTION DETAILS

- Construction material re-inforced blockwork or equivalent
- Internal shaft size 1550mm (w) x 1830mm (d)
- Pit depth 150mm - 160mm (depending on floor coverings)
- Headroom 2400mm - 2500mm - 2580mm - 2800mm
- Lift machine area up to 7m away at landing of choice
- Power supply single phase 240V 32A or 3 phase, 415V 20A
- Doors sizes from 650mm - 1000mm in 50mm increments  
different jambs may have alternate impact

## STANDARD SPECIFICATIONS

- Person capacity 350 - 400kg
- Speed 0.30 m/s
- Maximum travel 12m
- Safety protection full height sensor beams
- Maximum floors 6
- Compliance AS1735.16/18 NCC E3.6
- Cabin fit out from our huge range of options
- Doors finishes from our huge range of options